

BUILDING AREA:	
NEW POLICE STATION: GROUND FLOOR =	9,495 SF
RENOVATED FIRE STATION: LOWER FLOOR =	4,113 SF
FIRST FLOOR =	9,501 SF
TOTAL RENOVATION =	14,214 SF
ADDITION FIRE STATION: GROUND FLOOR =	12,095 SF
TOTAL FIRE ST. (RENOV. + ADD.) =	26,309 SF
TOTAL (POLICE ST. + FIRE ST.) =	35,824 SF

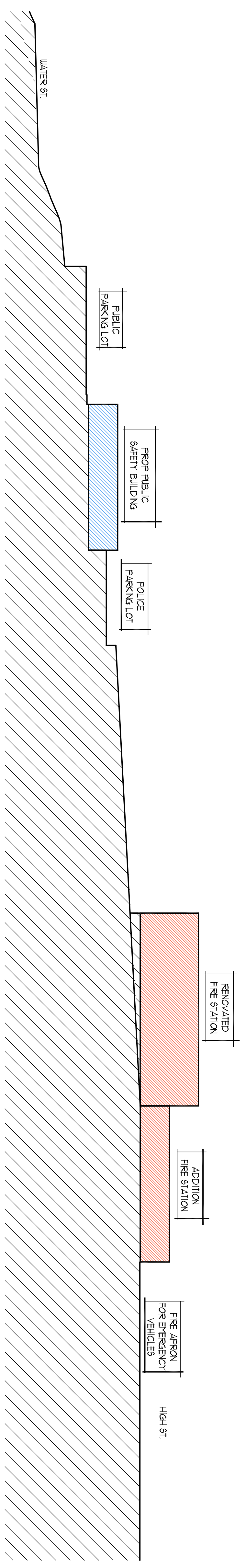

1 SITE PLAN
SCALE: 1/32" = 1'-0"



2 SECTION - LOCATION TO BE DETERMINED
SCALE: 1/32" = 1'-0"

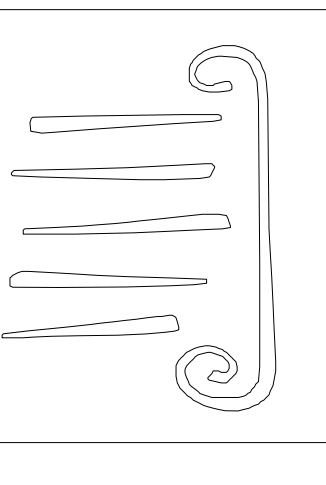

65 NEWBURY STREET
PORTLAND, ME 04101
207.761.9000
fax: 207.761.2010

OPTION C

CITY OF CARBON
PUBLIC SAFETY
BUILDING
CARBON, MAINE

SHEET NAME
SITE PLAN

Drawn By
lrs
Checked By
lrs
C-S11

Date Issued September 16, 2013
Project Number 171411

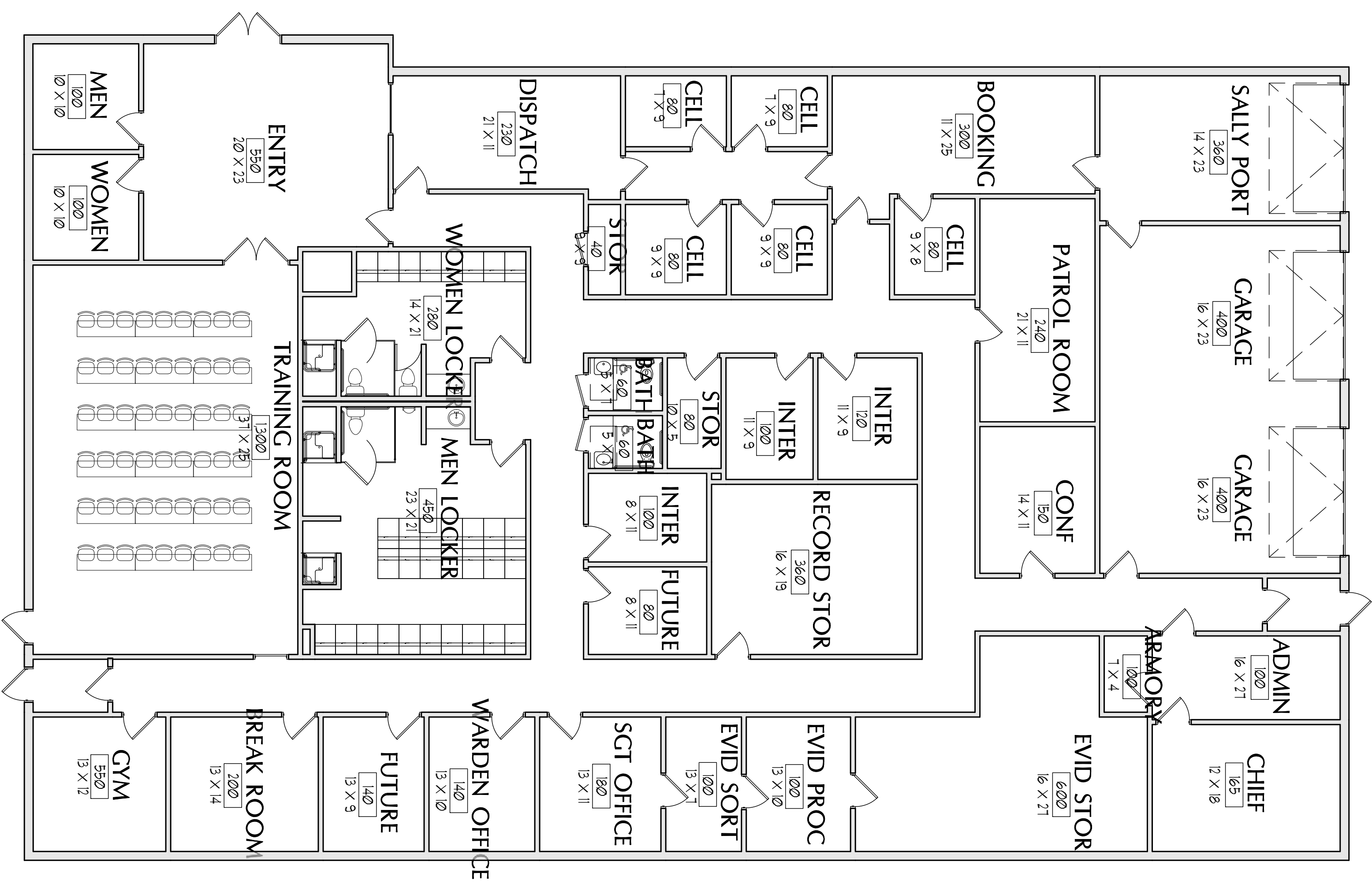
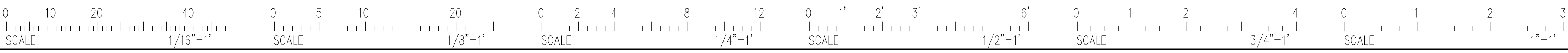

1 POLICE STATION - FLOOR PLAN
 0' 8'-0"
 SCALE: 1/8" = 1'-0"

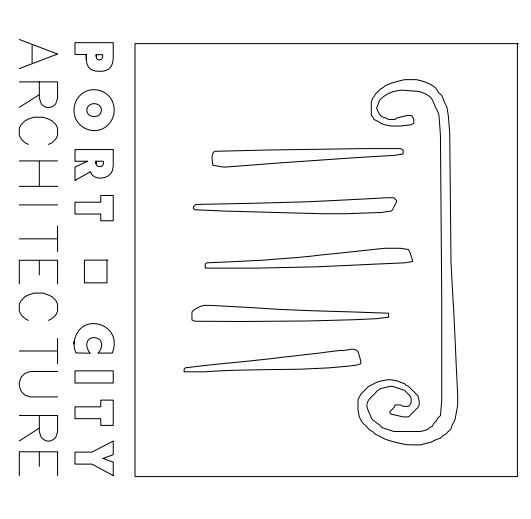

**CITY OF CARBON
 PUBLIC SAFETY
 BUILDING
 CARBON, MAINE**

Date Issued: September 16, 2013
 Project Number: 171411

Scale: SHEET NAME: STAND ALONE POLICE STATION
 Drawn By: lae
 Checked By: lae
C-A.1

COPYRIGHT: Reuse or reproduction of the contents of this document is not permitted without written permission of PORT CITY ARCHITECTURE PA

